

ADOLPHUS ROAD, LONDON N4

Bright airy one bedroom top floor flat offered in good condition and benefitting from a light reception with lovely outlooks, good size bedroom, modern fitted kitchen, attractive bathroom, own stairwell and share of freehold.

Located within easy reach of Finsbury Park Victoria, Piccadilly and Main Line Station and excellent Bus Services.

The beautiful Green Flag Award Winning Finsbury Park is very close by.

£399,950 Share of Freehold

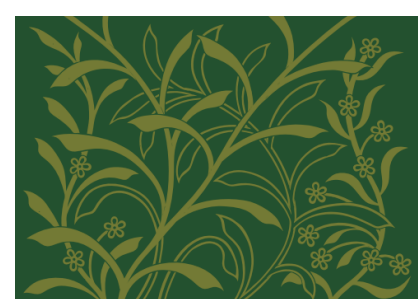

Michael Morris
Estate Agents

11 Blackstock Road, London N4 2JF Tel: 0207 354 8899
81 Stroud Green Road, London N4 3EG Tel: 0207 281 0129
info@michaelmorris.co.uk | <https://www.michaelmorris.co.uk>



ADOLPHUS ROAD, LONDON
N4

Adolphus Road N4, 2AZ

Approximate Gross Internal Area = 53.4 sq m / 575 sq ft

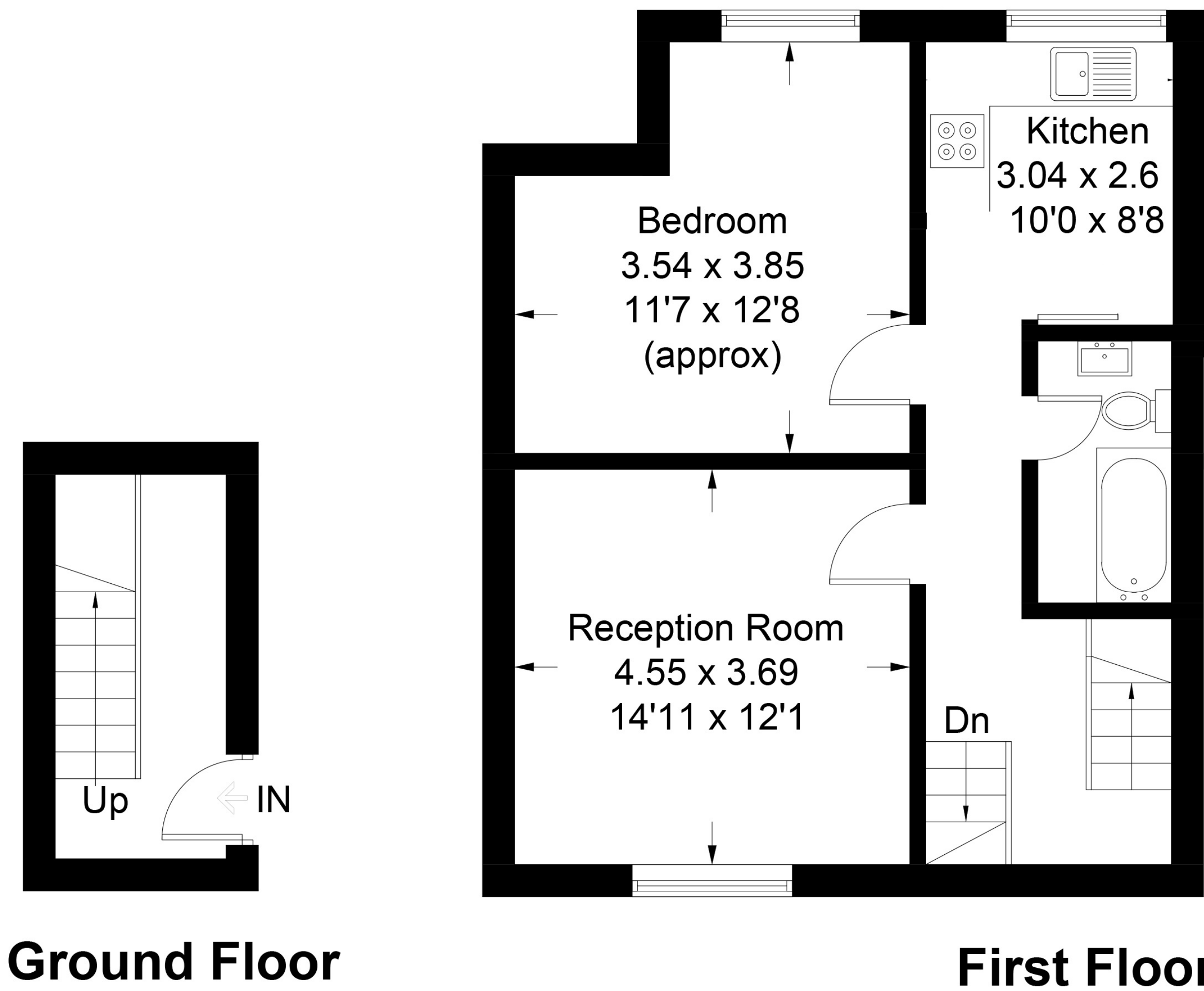

Illustration for identification purposes only, measurements are approximate, not to scale. FloorplansUsketch.com © 2017 (ID310445)

Important Notice

Michael Morris, their clients and any joint agents give notice that:1: They are not authorised to make or give any representations or warranties in relation to the property either here or elsewhere,either on their own behalf or on behalf of their client or otherwise.They assume no responsibility for any statement that may be made in these particulars. These particulars do not form part of any offer or contract and must not be relied upon as statements or representations of fact. 2: Any areas, measurements or istance are approximate. The text, photographs and plans are for guidance only and are not necessarily comprehensive. It should not be assumed that the property has all necessary planning, building regulation or other consents and Michael Morris have not tested any services, equipment or facilities. Purchasers must satisfy themselves by inspection or otherwise.